

BOC - Direct hook-up distribution block on copper busbars

Brass distribution block for 5 and 10 mm thick copper bars. Made of:

- 8-output distribution block for direct connection on 25 mm pitch prepunched bars), with hex socket head cap screws
- no-punching connection unit on solid copper bar

ADVANTAGES

The connection unit can be used as a guide to make punching the 5 and 10 mm thick bars easier. Spacing two or three pre-punched bars becomes simple using the connection unit as a guide. Simple and quick derivations with cables up to 16 and/or 25 mm² (with ferrule) that can be used up to 400 A.

Use with solid bar:

- use both the units
- two mounting possibilities
- Screw sets M8 not included

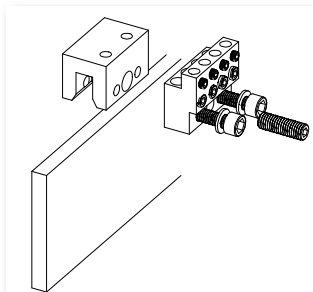
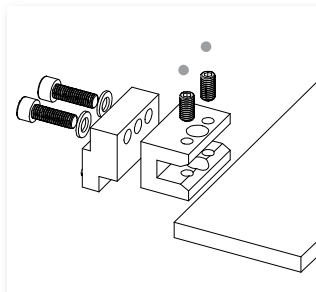

Use with prepunched bar:

- use only the distribution block unit on single bar phase systems.
- use both units on multi bar phase systems

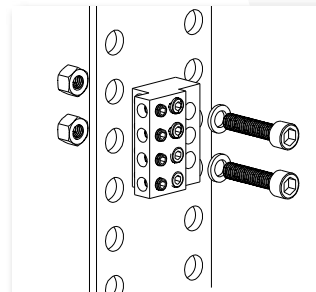

Code	Reference		Weight (kg)	A (mm)	B (mm)	C (mm)	C1 (mm)	D (mm)	(Nm)
BOC1000	BOC RIP 8 *	12	0,22	50	30	-	22	-	
BOC1005	BOC KIT 8 - 5 **	12	0,39	50	30	37	22	5	10
BOC1010	BOC KIT 8 - 10 ***	12	0,51	50	30	52	22	10	10

* 8 output distribution block unit

** 8 output distribution block unit + connection unit on 5 mm thick bar

*** 8 output distribution block unit + connection unit on 10 mm thick bar

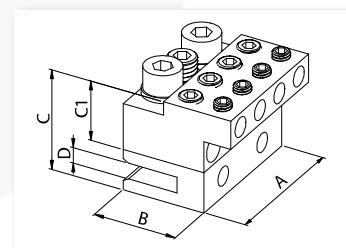

Code	IN/OUT	Stripped cable sect. (mm ²)	Cable sect. with ferrule (mm ²)	No.	Ø (mm)	(Nm)
BOC1000	← OUT	2,5 ÷ 25	2,5 ÷ 16	4	7	3
BOC1005 BOC1010	← OUT	4 ÷ 35	4 ÷ 25	4	9	3,5